



to compliance
OSHA'S Lockout Tagout Standard
29 CFR, 1910.147&1910.269



www.lotoappliances.com



GSTIN No.: 06AAECK2831L1ZI
PAN No.: AAECK2831L
TIN No.: 06824000112
CIN No.: u31903HR2011PTC042508

Telefax: 00 91 129 4021 381, 413 1381 (D)

Regd. Office: 1H/31-A, N.I.T, Faridabad-121001 (Haryana) Postal Office: 615, Sector-15-A, Faridabad-121007-Haryana-NCR-INDIA

www.krmcorporation.com | www.lockouttagouts.com | www.krmloto.com | www.locktagindia.com | www.lotoappliances.com

KRM LOTO – AIR CIRCUIT BREAKER LOCKOUT





to compliance
OSHA'S Lockout Tagout Standard
29 CFR, 1910.147&1910.269



www.lotoappliances.com



GSTIN No.: 06AAECK2831L1ZI
PAN No.: AAECK2831L
TIN No.: 06824000112
CIN No.: u31903HR2011PTC042508

Telefax: 00 91 129 4021 381, 413 1381 (D)

LOCKOUT TAGOUT DEVICE



KRM-K-DEH-33

KRM-K-MIESLD-1

KRM-K-RSDEL

KRM-K-MIESLD-2

- ① DI-ELECTRIC HASP LOCKOUT SHACKLE THICKNESS 3 MM
- ② MULTIPURPOSE INDUSTRIAL ELECTRICAL PENAL LOCKOUT DEVICE (WITH BEND)
- ③ ROUND SHAPE DI-ELECTRIC LOCKOUT DEVICE
- ④ MULTIPURPOSE INDUSTRIAL ELECTRICAL PENAL LOCKOUT DEVICE (STATE)

GSTIN No.: 06AACPW8746Q1Z6,
PAN No.: AACPW8746Q
TIN No.: 06821328889,
TAN no.: RTKKO3359G

M: 00 91 9810 291 381, 8800 544 881

Regd. Office: 1H/31-A, N.I.T, Faridabad-121001 (Haryana) Postal Office: 615, Sector-15-A, Faridabad-121007-Haryana-NCR-INDIA

www.krmcorporation.com | www.lockouttagouts.com | www.krmloto.com | www.locktagindia.com | www.lotoappliances.com



Lock Tag!!

safe loto

KRM Safetech Private Limited

to compliance
OSHA'S Lockout Tagout Standard
29 CFR, 1910.147&1910.269



www.lotoappliances.com



GSTIN No.: 06AAECK2831L1ZI
PAN No.: AAECK2831L
TIN No.: 06824000112
CIN No.: u31903HR2011PTC042508

Telefax: 00 91 129 4021 381, 413 1381 (D)

1. KRM-K-DEH-33



2. KRM-K-MIESLD-1

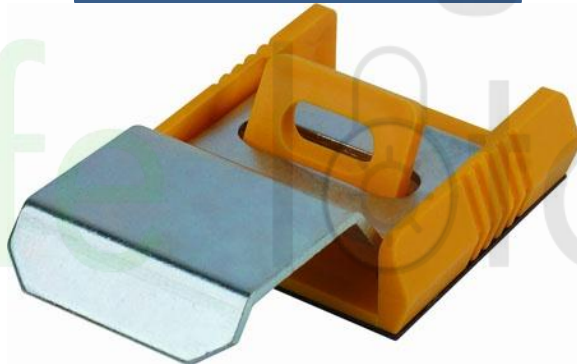

3. KRM-K-RSDEL



4. KRM-K-MIESLD-2



GSTIN No.: 06AAPW8746Q1Z6,
PAN No.: AAVPW8746Q
TIN No.: 06821328889,
TAN no.: RTKKO3359G

M: 00 91 9810 291 381, 8800 544 881



to compliance
OSHA'S Lockout Tagout Standard
29 CFR, 1910.147&1910.269

Lock Tag!!



www.lotoappliances.com

safe loto



KRM Safetech Private Limited

GSTIN No.: 06AAECK2831L1Z1
PAN No.: AAECK2831L
TIN No.: 06824000112
CIN No.: u31903HR2011PTC042508

Telefax: 00 91 129 4021 381, 413 1381 (D)

Regd. Office: 1H/31-A, N.I.T, Faridabad-121001 (Haryana) Postal Office: 615, Sector-15-A, Faridabad-121007-Haryana-NCR-INDIA

www.krmcorporation.com | www.lockouttagouts.com | www.krmloto.com | www.locktagindia.com | www.lotoappliances.com

KRM LOTO NON CONDUCTIVE HASP WITH 4 HOLES SHACKLE THICKNESS 3 MM

- KRM Di-electric slider Hasp's body is in three parts made of strong rigid plastic having excellent insulating characteristic and highly resistant to the chemical and can be utilized in magnetic field. Having totally four holes to placed padlocks for standardized isolation.
- Material** – ABS
- Size** – height 65 mm, width 62 mm (Top and Bottom), thickness 12 mm, shackle thickness is 3 mm for thin shackle size, shackle width 55 mm.
- Weight** – 50 gm for thin shackle with 4 holes
- Color** – Yellow body with black shackle, Yellow body with red shackle Or any color make as per the required quantity



KRM-K-DEH-33

| ITEM CODE | OUTER LENGTH | SHACKLE THICKNESS | PADLOCK | NO OF HOLES | WEIGHT |
|--------------|--------------|-------------------|---------|-------------|--------|
| KRM-K-DEH-33 | 65 mm | 03 mm | 7.5mm | 04 | 50 gm |



KRM LOTO-ROUND SHAPE DI ELECTRIC LOCKOUT

- Material** - Body made of ABS, attached with rivet.
 Round Shape Di Electric lockout device is used to lock the racking in-out point of air circuit breaker and Vacuum circuit breaker so that no one can operate the particular device, also can lock some sort of switches that are inserted inside a plain surface
- Made by riveting two pieces which can be easily rotated in any direction having three holes at bottom part to fix with the screw and also can be stuck with the strong double sided pre adhesive on requirement for locking purpose.
- Dimension** - Outer diameter is 46 mm, Inner diameter is 32 mm, lower cover circle side thickness is 7 mm, overall thickness is 8 mm with upper part thickness is 3 mm and lower part thickness is 5 mm, locking hole diameter is 7 mm.
- Weight** - 20 gms
- Color** - Standard Color Yellow.



KRM-K-RSDEL



| MODELS | OUTER DIAMETER | INNER DIAMETER | CIRCLE SIDE THICKNESS | OVERALL THICKNESS | LOWER THICKNESS | WEIGHT |
|-------------|----------------|----------------|-----------------------|-------------------|-----------------|--------|
| KRM-K-RSDEL | 46mm | 32mm | 07mm | 18mm | 07m | 20gm |



to compliance
OSHA'S Lockout Tagout Standard
29 CFR, 1910.147&1910.269

Lock Tag!!



www.lotoappliances.com

safe loto



KRM Safetech Private Limited

GSTIN No.: 06AAECK2831L1Z1
PAN No.: AAECK2831L
TIN No.: 06824000112
CIN No.: u31903HR2011PTC042508

Telefax: 00 91 129 4021 381, 413 1381 (D)

KRM LOTO - MULTIPURPOSE INDUSTRIAL ELECTRICAL SAFETY LOCKOUT DEVICE – I

- Material - Made from ABS and mild steel plate.
- Size of Yellow part : 53x51 mm with provision of hole.
- Size of Metal part : 78.5mm x 40 mm , but cantilever part from yellow base : 40mm x 40mm x 23 mm (center height)
- Base yellow can be fixed by double sided tape or screw.
- Different shape lockouts can be customized on quantity basis.
- Can put over button switch and lock hole for distribution cabinet's lockout device as shown in image to prevent accident.
- Always use Lockout Tagout while shutdown and maintenance work.



KRM-K-MIESLD-I

GSTIN No.: 06AAVPW8746Q1Z6,
 PAN No.: AAVPW8746Q
 TIN No.: 06821328889,
 TAN no.: RTKKO3359G

M: 00 91 9810 291 381, 8800 544 881

Regd. Office: 1H/31-A, N.I.T, Faridabad-121001 (Haryana) | Postal Office: 615, Sector-15-A, Faridabad-121007-Haryana-NCR-INDIA

www.krmcorporation.com

www.lockouttagouts.com

www.krmloto.com

www.locktagindia.com

www.lotoappliances.com



Lock Tag!!



www.lotoappliances.com

safe loto



KRM Safetech Private Limited

GSTIN No.: 06AAECK2831L1Z1
 PAN No.: AAECK2831L
 TIN No.: 06824000112
 CIN No.: u31903HR2011PTC042508

Telefax: 00 91 129 4021 381, 413 1381 (D)

KRM LOTO - MULTIPURPOSE INDUSTRIAL ELECTRICAL SAFETY LOCKOUT DEVICE - II

- Material - Made from ABS and mild steel plate.
- Size of Yellow part : 53x51 mm with provision of hole.
- Size of Metal part : 88 mm x (40 + 35 at end of part) mm , but cantilever part from yellow base : 40mm x 40 + 35 at end of part) mm
- Yellow Base Part can be fixed by double sided tape or screw.
- Different shape lockouts can be customized on quantity basis.
- Put over low voltage drawer, electrical panel door or over electric handle hole for lockout device as shown in image to prevent accident.
- Always use Lockout Tagout while shutdown and maintenance work.

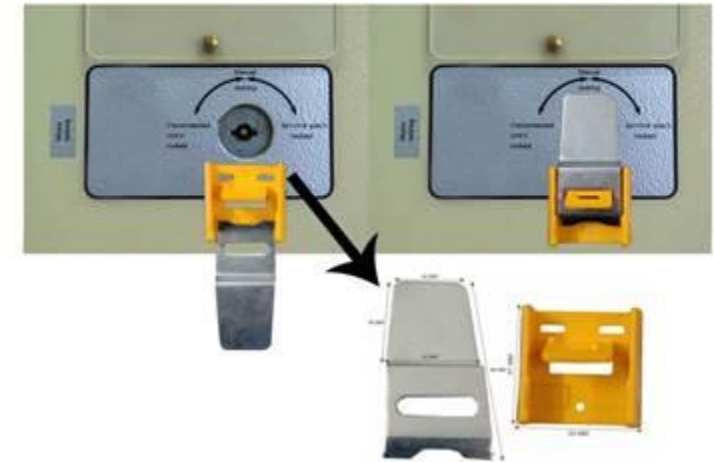

KRM-K-MIESLD-II